

# MORTISE INSTALLATION INSTRUCTIONS

202220680

## STEP 1. LATCH INSTALLATION INSTRUCTIONS

•**IMPORTANT - DOOR JAMB ("Z"-BAR) HAS OPENINGS FOR BOLT EXTENSION. THE WOOD IN THESE OPENINGS MUST BE REMOVED TO A DEPTH OF 3/4" BEFORE OPERATING THE DEADBOLT WITH THE DOOR CLOSED. SEE STEP 3A ON REVERSE SIDE OF INSTRUCTIONS.**

**A.** From outside of door, determine if your door is a right hinged or a left hinged door. **See Fig. 1**

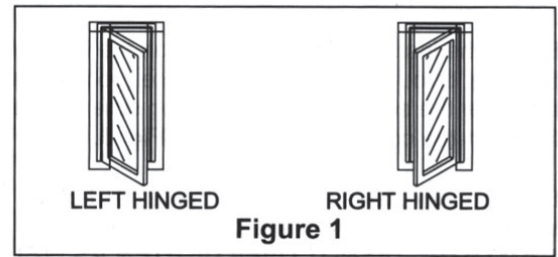

**B.** If the bolt orientation of the mortise plate and latch assembly matches your door go to **Step C**. **See Fig. 2**. If the bolt orientation is incorrect for your door, remove the #10-32 x 5/8" screw and mortise plate, rotate the latch bolt 1/2 turn (180°) and reattach the mortise plate to the latch assembly. **See Fig. 2**

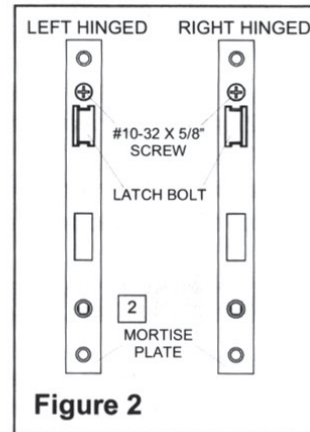

**C.** Insert latch assembly into end of door panel per **Fig. 3**. Do not fasten at this time. Fastening will be completed in **Step 2G**.

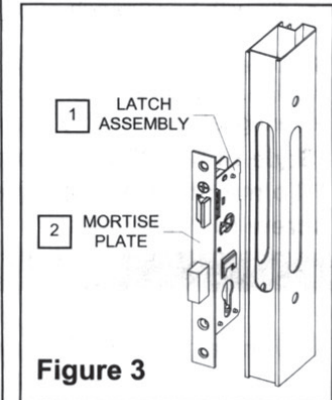

## STEP 2. HANDLE AND ESCUTCHEON PLATE ASSEMBLY

**A.** On the inside of the door, insert key cylinder through the latch assembly, aligning the screw hole in the key cylinder with the hole in the mortise plate. (The turn knob goes on the inside of the door). Insert the #10-32 ph fl hd screw into the mortise plate and key cylinder. Prior to tightening the screw, turn the key cylinder to extend the deadbolt. **See Fig. 4**

**B.** Insert one of the handles through the T-bushing and outside trim plate. **See Fig. 5**

**C.** On the back of the outside trim plate, place the flat nylon washer over the handle and slide the D-clip over the flat nylon washer, making sure that the D-clip is oriented vertically. Insert the square spindle all the way into the handle. Using hex wrench provided, tighten the set screw on the underside of the handle to hold the spindle in place.

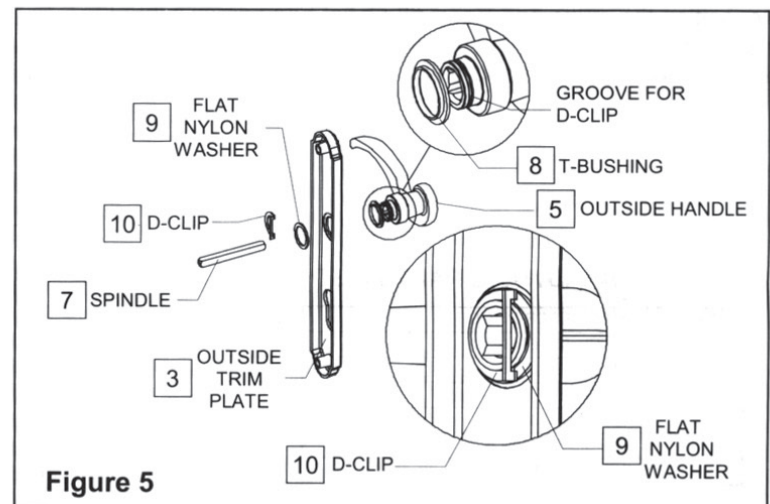
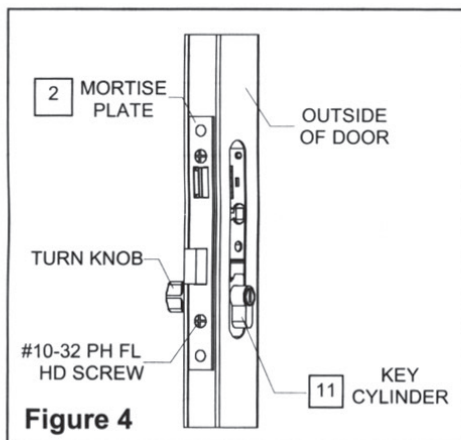

### Additional Feature: "Keyed Alike"

Your Larson storm door can be keyed to match your existing entry door. To do this, take the storm door key cylinder and your entry door key to a local locksmith. The locksmith can rework the cylinder so that it will match your entry door. **NOTE:** Applies to Schlage® or Kwikset® brand entry door locks only.

D. From the outside of the door, insert the outside handle/trim plate/spindle assembly through the square hole in the latch assembly, making sure that the lever handle is facing in the correct direction. **See Fig. 6**

E. On the inside of the door, position the inside handle, with T-bushing, through the inside trim plate (polished surface facing out) and over the square spindle, making sure that the inside lever is facing in the correct direction. **See Fig. 6.**

F. Align trim plates and install the (2) #10-32 ph pan head screws through the top and bottom holes on the inside trim plate. **CAUTION: DO NOT OVERTIGHTEN AS WALLS MAY BEND.** Hold the handles tightly together and tighten set screw on inside handle with hex wrench.

G. On edge of door, centerpunch and drill 1/8" pilot holes and install mortise plate to edge of door with (2) #8 ph flat head screws, securing latch assembly to the door.

**\*Style of handles and plates shown may vary from those packaged in your hardware kit.**

**\*\*To maintain proper operation of your door hardware, periodically check your mounting screws and set screw for tightness.**

**Figure 6**

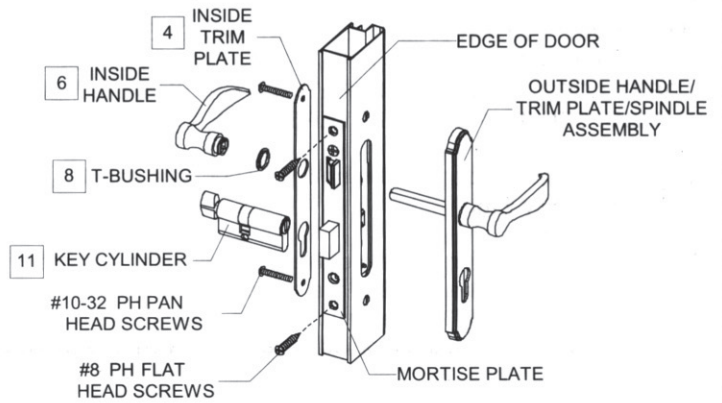

### STEP 3. STRIKE INSTALLATION

A. Using a drill and chisel, clear the wood from the strike openings behind the "Z" bar 3/4" deep. **See Fig 7. NOTE: Deadbolt must have clearance on all four sides.**

B. With the door open, extend the dead bolt fully. Carefully close door until dead bolt contacts the z-bar. With a pencil, mark the location of the top and bottom of the dead bolt onto the z-bar. **See Fig. 8.** Return the dead bolt to the fully retracted position.

C. Position the strike plate on the latch side z-bar. Align the strike vertically by centering the bottom hole in the strike plate with the marks previously made on the z-bar. **See Fig. 9**

D. Position the strike horizontally by aligning the outside edges of the top and bottom slots in the strike plate with the outside edges of the top and bottom slots in the z-bar. Mark the hole locations in the center of the two adjustable slots. **See Fig. 9.**

E. Remove the strike and drill the marked holes with a 3/32" drill bit. Reposition the strike and insert #8 ph flat head screws into the mounting holes and tighten. Close the door and check for proper operation of latch and dead bolt. Adjust the strike if needed.

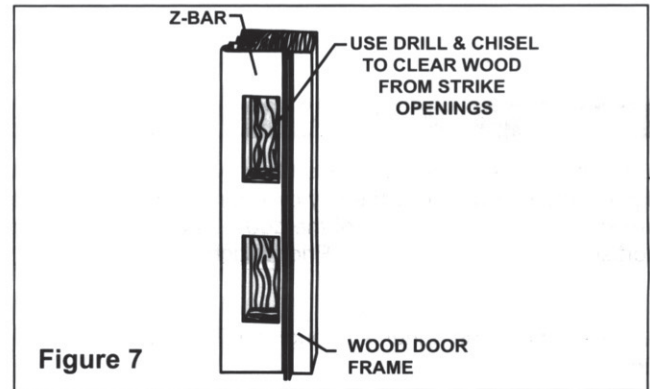

**Figure 7**

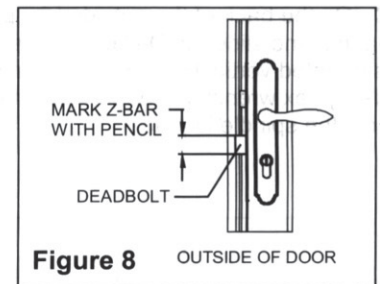

**Figure 8** OUTSIDE OF DOOR

#### HARDWARE PARTS LIST

ITEM #	PART DESCRIPTION	QTY
1	LATCH ASSEMBLY	1
2	MORTISE PLATE	1
3	OUTSIDE TRIM PLATE	1
4	INSIDE TRIM PLATE	1
5	OUTSIDE HANDLE	1
6	INSIDE HANDLE	1
7	SPINDLE	1
8	T-BUSHING	2
9	FLAT WASHER	1
10	D-CLIP	1
11	KEY CYLINDER	1
12	STRIKE	1
13	PAN & FLAT HEAD SCREWS (PKG)	1

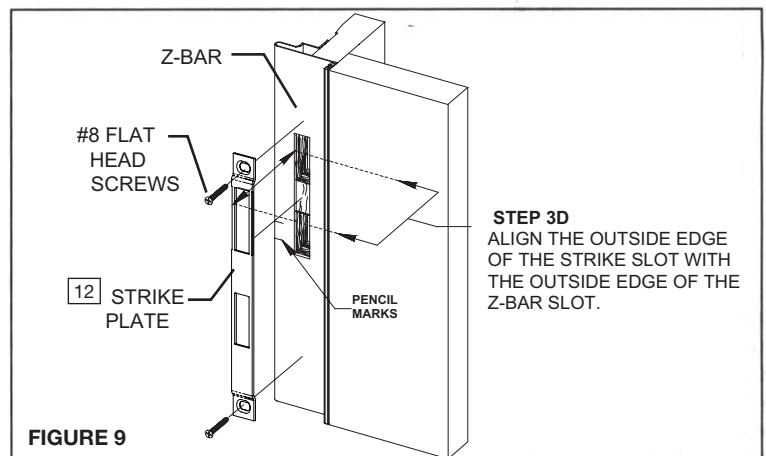

**FIGURE 9**