

MORTISE LEVER LOCKSET INSTALLATION INSTRUCTIONS

PART # 202220676

1 BEFORE INSTALLATION

Please read these instructions thoroughly before attempting installation.

2 TOOLS NEEDED

Phillips screwdriver, tape, pencil, power drill with 3/32", 1/8", 3/8" and 9/16" drill bits.

3 DRILLING INSTRUCTIONS

1. Tape the template on the **inside** of the storm door as indicated on the template. Fold template along dotted line prior to taping.
2. Follow the drilling instructions on the template. Drill holes straight through door (FIG. 2).

NOTE: Drill 1/8" pilot hole on all holes.

4 LATCH INSTALLATION

1. Insert latch assembly into latch hole (FIG. 3).
2. Check if latchbolt bevel faces the correct direction for your door.
3. Mount latch assembly securely to door with 2x3/4" combo screws (FIG. 4).

FIG.2

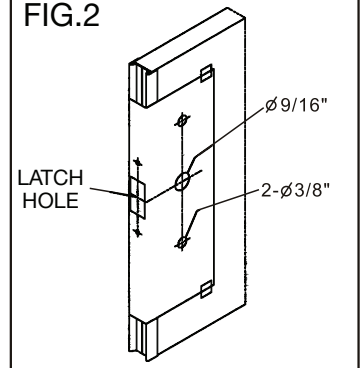

FIG.3

OUTSIDE

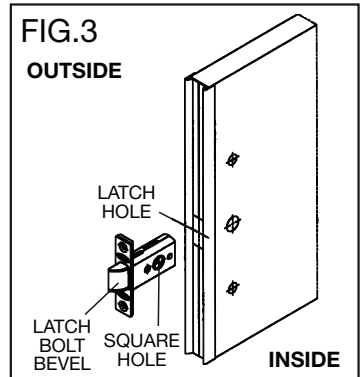

FIG.4

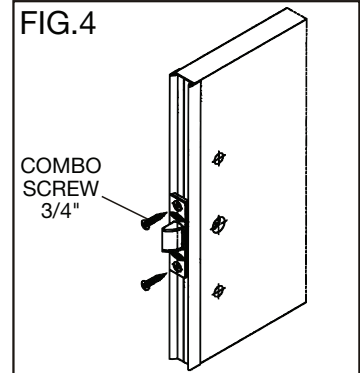
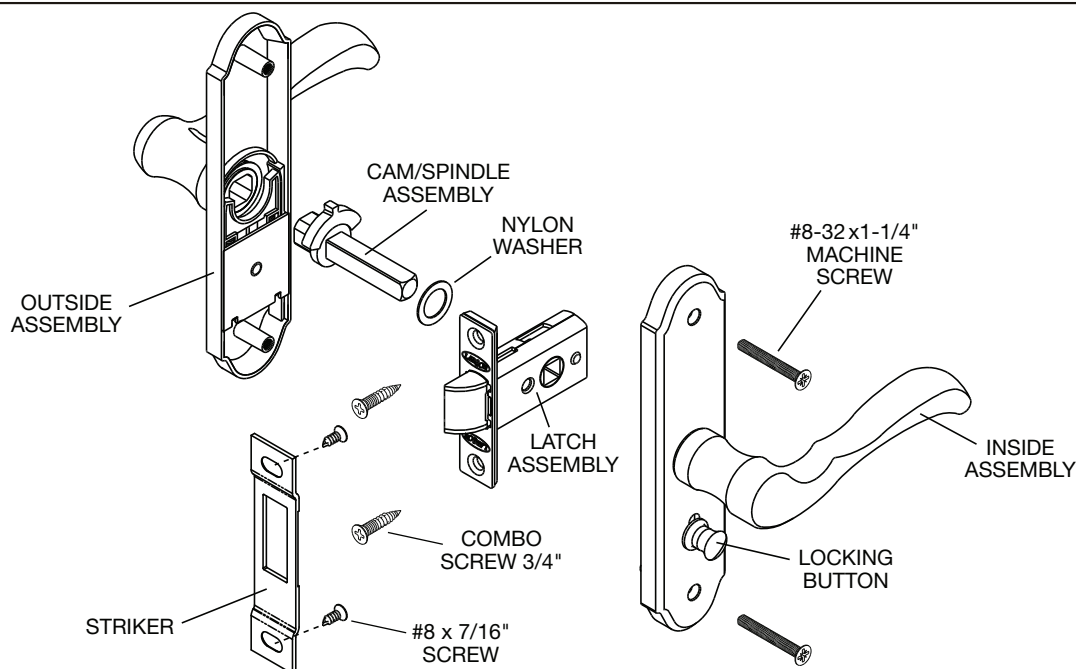

FIG.1



5

LOCK INSTALLATION

1. Make sure nylon washer is installed. (FIG.5) Turn outside lever to correct direction and place cam/spindle assembly all the way into the spindle hole of the outside assembly.
2. From the outside of the door, insert spindle through the square hole in the latch (FIG.6) and hold the outside assembly flush against the outside door face. From the inside of the door, turn the lever on the inside assembly to align with the spindle and mount the inside assembly flush against the inside door face (FIG.7). Then, secure the inside assembly with #8-32x1-1/4" machine screws.

NOTE: Do not over tighten the screws as hardware may bind.

FIG.5

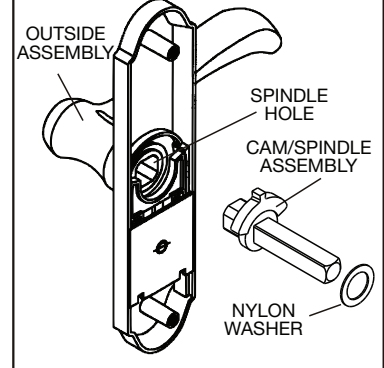

6

STRIKER INSTALLATION

1. Close door until latchbolt touches jamb. From outside of door, mark latchbolt on jamb with a pencil. (FIG.8)
2. Place striker on jamb and vertically align striker hole with pencil mark. (FIG.9)
3. Mark hole location on jamb in the center of 2 adjustable slots and drill 3/32" pilot holes at marked locations. Then tighten with #8x7/16" screws. (FIG.9) Close door to check if latchbolt can extend and retract properly. Adjust striker if necessary.

FIG.6 OUTSIDE

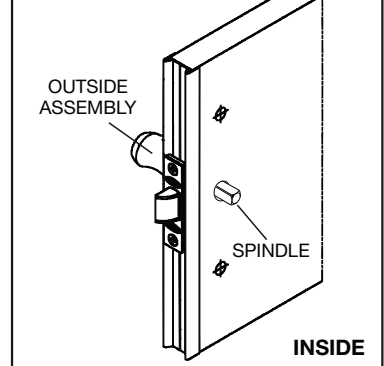

7

LOCKING, UNLOCKING, AND LATCHING

1. Push locking button up to lock both inside and outside levers. (FIG.10)
2. Push locking button down to unlock both inside and outside levers.
3. Depress inside or outside lever to unlatch.

FIG.7

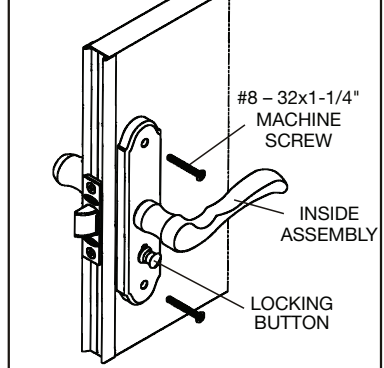

8

HARDWARE PARTS LIST

ITEM#	PARTS DESCRIPTION	QTY.
1	OUTSIDE ASSEMBLY	1
2	LATCH ASSEMBLY	1
3	INSIDE ASSEMBLY	1
4	CAM/SPINDLE ASSEMBLY	1
5	NYLON WASHER	1
6	STRIKER	1
7	#8 - 32 x 1-1/4" MACHINE SCREW	2
8	COMBO SCREW 3/4"	2
9	SCREW#8 x 7/16"	2

FIG.10

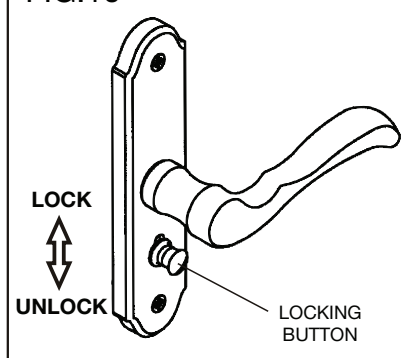

FIG.9

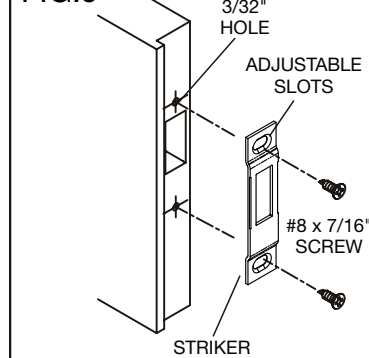

FIG.8

